

NEW SOUTHWEST ELEMENTARY SCHOOL FACILITY PROJECT SHEET

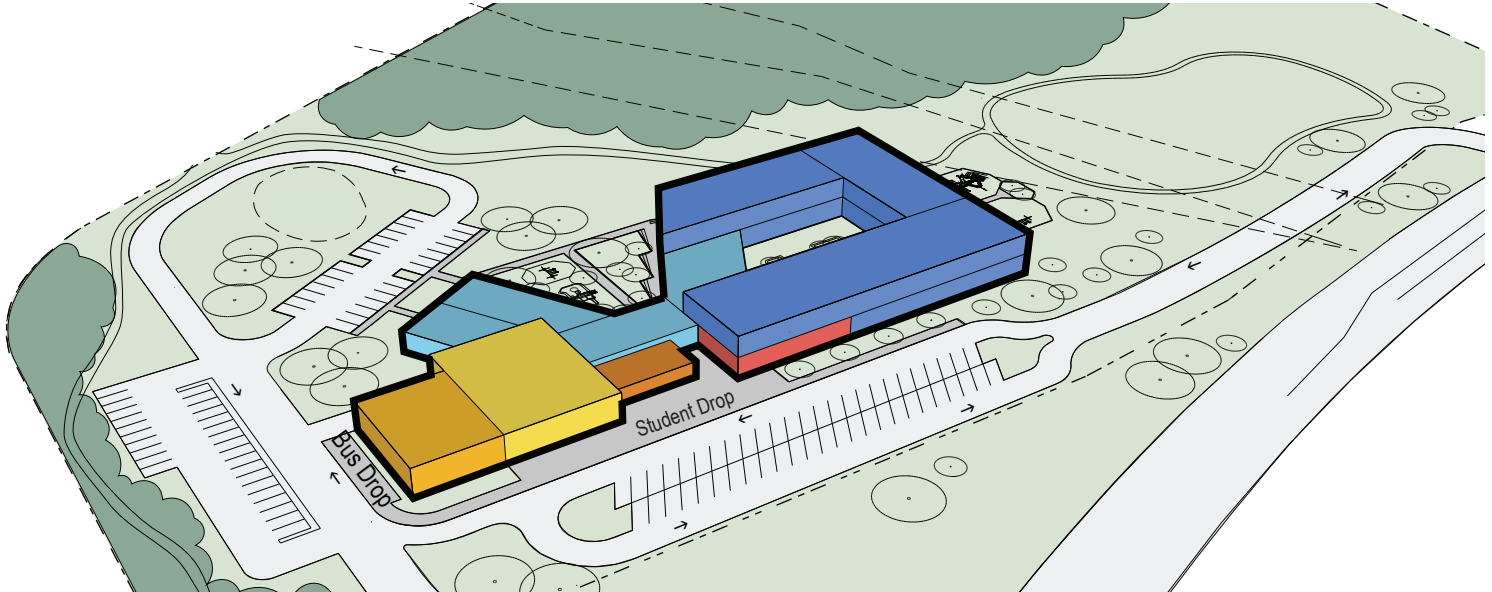

Site Location: Southeast of
Trissino Dr. and Escarpment Blvd.

Building Area: 70,725 Square Feet
Planned Capacity: 522

About the Project

This school is intended to provide immediate overcrowding relief for both Baranoff and Kiker Elementary Schools.

Proposed Projects

- New School Construction to be Based Around the New AISD Educational Specifications to Create a State-of-the-Art Facility with Increased Capacity
- Technology: Teacher Computers
- Technology: Computer Lab Improvements

For more detailed information about the district's long-term Facility Master Plan and recommendations for this facility, please visit www.aisdfuture.com.

Facility Condition Assessment (FCA)

District Average - Elementary	Before Improvements	After Improvements
52	N/A	90+

● Fail < 30	● Poor 30 - 49	● Average 50 - 69	● Good 70 - 89	● Excellent 90 - 100
--	--	---	---	---

Educational Suitability Assessment (ESA)

District Average - Elementary	Before Improvements	After Improvements
62	N/A	90+

● Fail 20 - 35	● Poor 36 - 50	● Average 51 - 65	● Good 66 - 80	● Excellent 81 - 100
---	--	---	---	---

Estimated Cost of Proposed Projects

\$36,227,000

Projects may include funding from additional sources.

The FCA and ESA scores are a representation of the condition of the facility only, not of the school's academic performance.

NEW SOUTHWEST ELEMENTARY SCHOOL FACILITY PROJECT SHEET

PRELIMINARY PLANNING LAYOUT

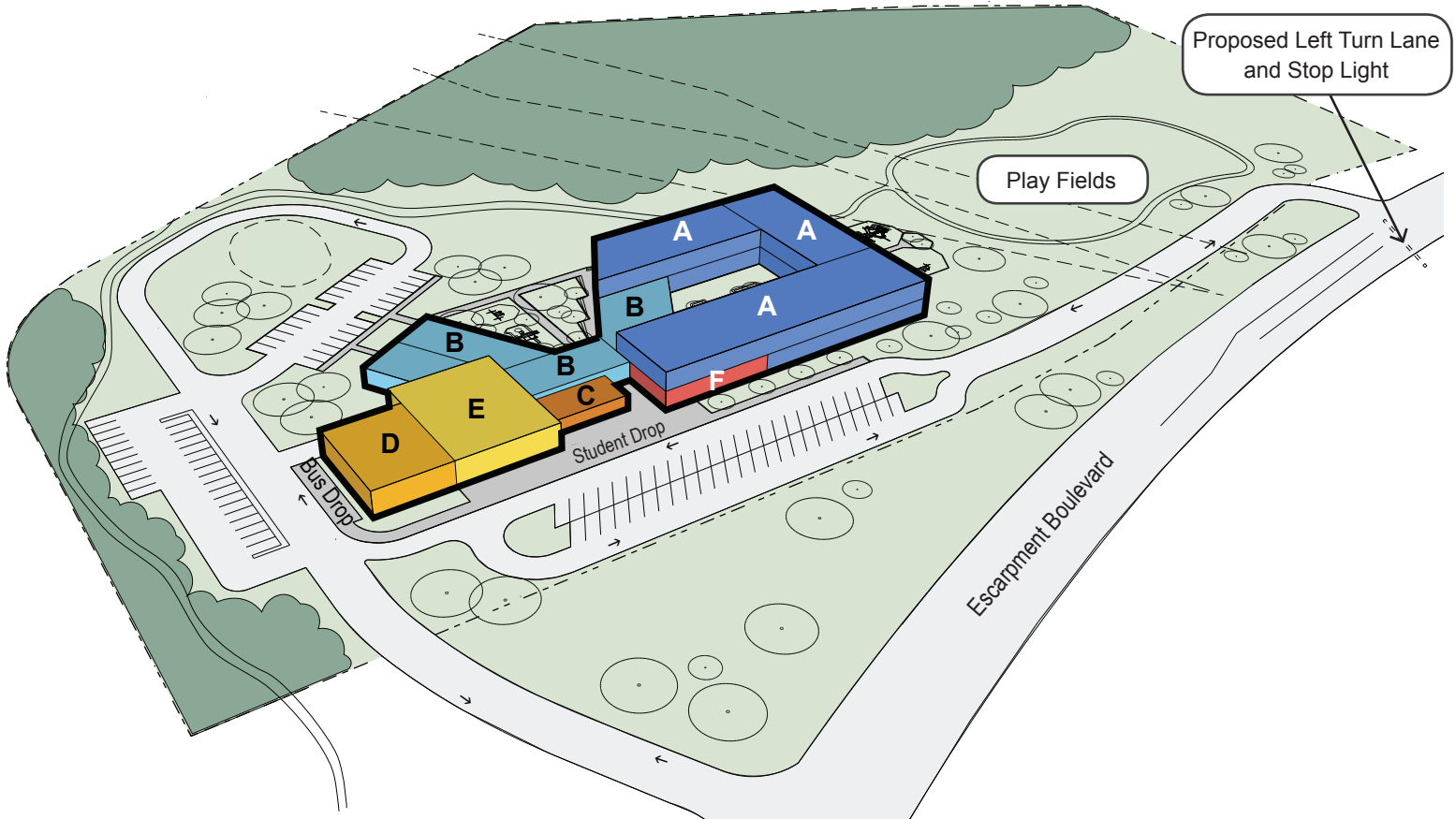

- | | |
|---|------------------------|
| A | CORE ACADEMIC SPACES |
| B | SHARED ACADEMIC SPACES |
| C | ADMINISTRATIVE SPACES |
| D | ATHLETIC SPACES |
| E | CAFETERIA + KITCHEN |
| F | MEDIA CENTER |
| | RENOVATION |
| | NEW CONSTRUCTION |