

Educational Suitability Summary Report

Blazier Elementary School (Primary and Intermediate Site)

Date: 12/21/2020

Score 84% Very Satisfactory

Blazier Elementary School, serving an enrollment of approximately 1,055 students, is in southeast Austin. The campus consists of two buildings: a primary school and an intermediate school. The original school opened in 2007 and a second building opened in 2020 as part of the 2017 bond program. The intermediate school was added to relieve overcrowding at the original campus and provide the first phase of a strategic plan to grow the school into a pre-K through eighth grade campus. The original school, now the primary building, supports kindergarten through third grades, and the new facility, known as the intermediate school, supports fourth through sixth grades.

The campus celebrates a 6-star rating with TEA and boasts high STAAR passing rates and earned an A rating in the 2019 accountability ratings among other distinction designations. Collectively, the school has a focus on dual-language learning and social-emotional learning.

A large, covered walkway at the front of each building creates welcoming entries. The building configuration at the original campus with four distinct studio wings provides access to daylight and facilitates wayfinding. The new building provides distinct and modern learning neighborhoods that foster a sense of academic community while providing flexibility for quiet/independent work.

Both sites are safely configured with separate bus loops, parent drop-off loops and pedestrian circulation areas. Spacious outdoor studios and community gardens provide plenty of opportunities for outdoor learning.

Interview Overview

The assessment team met virtually with Principal Leti Peña-Wilk, who is overall satisfied with the original primary building and the new intermediate building. When asked what is significant about the school and should not be changed, she noted that the outdoor spaces are very important to the school and the community. The primary building recently gained outdoor space when several portables were removed, and the students and teachers are enjoying this newly reclaimed space. The new intermediate facility provides outdoor gardens and areas for learning. The principal noted that the intermediate building's maker spaces, multipurpose rooms and community room have been successful this first year and she would not want to see them change.

Space still seems to be the main issue for the campus. The primary building struggles with adequate space for its programs. They have two classes each for gym, art and P.E and not enough available rooms to support them. They utilize a multipurpose room and a portable gym to mitigate the problem, but the portable gym is scheduled to be removed soon. At the intermediate building, there is not enough room for teacher workspace, grade level storage or general equipment storage. The demand for storage is so high that the new black box has been converted into a large work room/storage area. Areas that were stressed as an immediate need are at the primary building: teacher workspace,

Educational Suitability Summary Report
Blazier Elementary School

Perkins&Will

multipurpose areas and adult restrooms. At the intermediate building, spaces that are most needed are storage and lounge areas (with lockers) for the custodial team and more space for equipment and file storage.

The school would like more development of the outdoor spaces for learning. The primary building needs exterior furniture for a full studio with a shade covering to be able to take classes outside. The original building has great space for outdoor learning between wings but there is not a direct way to access it. At the intermediate building, there are new raised planting beds and an area with outdoor seating. The principal would like both buildings to have immediate access to outdoor learning with intentionally designed areas for presentations or group work.



Both buildings do their best to support new teaching and learning methods. The intermediate building has ample opportunities and spaces for students to create, collaborate and connect. The primary building struggles with some of its existing spaces. In the wings where there are open areas adjacent to the studios, the students and faculty use them whenever possible. The connected cafeteria and gym at the primary school help provide space for larger groups and assemblies.

Looking to the future, the campus would like to prioritize updating its primary building. Only one wing has a commons area for collaboration and group work. High priorities include providing another commons space for the second wing and including flexible spaces and operable partitions with access to outdoor learning. In addition, the primary building needs a dedicated space where families and the community can gather during and outside of school hours that can also host district meetings. The primary building also needs technology upgrades. The principal would like to move to one-to-one technology platform with less need for computer labs.

Assessment Findings

The Educational Suitability Assessment of Blazier Elementary School earned an 84% overall score and places the campus in a category of Very Satisfactory. The assessment consists of seven General Building categories and seven Academic categories to determine areas that need more attention. All scores were averaged between campuses.

Average Categories (51-65%):

Technology

Score is average.

Projections screens are dispersed in the specialty areas and a standard technology cart was observed in studios. There is an average of two outlet quads per wall in the primary building (eight total outlets per wall) and an average of two outlets per wall in the intermediate building (four total outlets). No charging locations were observed at either building. Media signage at the primary building is not in a location that can be easily viewed by a visitor.

Satisfactory Categories (66-80%):

Academics & Learning

Score is satisfactory.

The intermediate campus meets the Ed Spec. Primary building studios are large enough but cannot be connected to an adjacent studio and there is limited visibility from the studio to the corridors, which hinders student use of the area. There are areas for collaboration outside studios, but no furniture is present. No maker spaces or PLCs were observed.

Controllability of Systems

Score is satisfactory.

At the primary building, manual thermostats were observed in all studios, but they did not display temperatures. Blinds are used in the primary building with damage to about 25% of them. Manual roller shades were still being installed at the intermediate building at the time of the assessment.

Furniture, Fixtures, Equipment

Score is satisfactory.

While the intermediate building conforms to current district standards, the primary building has outdated furniture. Studios have standard desks with unattached chairs. There are not multiple options for teaching spaces and the desks are bulky and difficult to move. The original building's cafeteria has standard cafeteria tables with attached stools only. No furniture was observed in the primary building's open collaboration areas or neighborhoods.

Very Satisfactory Categories (81-100%):

Outdoor Learning and Activity

Score is very satisfactory.

The intermediate building meets current district standards. The primary building does not have an outdoor studio and the gardens are small and not well-maintained. Two small water cisterns were observed on the primary building site.

PE and Wellness

Score is very satisfactory.

Both gym areas are sized appropriately with good storage, adjacent restrooms and access to the exterior. The original building restrooms are a little undersized but in good condition.

Food Services

Score is very satisfactory.

The intermediate building meets the district standards. The primary building has no outdoor dining and only one seating option.

Security

Score is very satisfactory.

Environmental Quality

Educational Suitability Summary Report
Blazier Elementary School

Perkins&Will

Score is very satisfactory.

All learning spaces have lots of daylight and access to exterior views. Acoustics between studios is adequate. The primary building had a smell at the group restrooms between the administration offices and the media center during the assessment.

Visual and Performing Arts

Score is very satisfactory.

Both buildings have appropriately sized spaces, and they are in good condition.

Media Resources

Score is very satisfactory.

Media centers at both buildings are in good condition with technology and flexible furniture. No small group rooms were observed at either building.

Administration Spaces

Score is very satisfactory.

Both buildings have a nice reception area to serve as a checkpoint with digital media. The primary building's reception is a little undersized but adequate to support a couple of chairs.

General Building

Score is very satisfactory.

Both buildings are in great condition and instill a sense a pride for this community. The community can access either building for after-hours functions without full school access. The intermediate building has a large, spacious community room and a conference room for community use.

Exterior

Score is very satisfactory.

Both buildings have well-defined entries with a monument sign at the road. They both have covered drop-off areas and are well-maintained.

Supporting Photographs



Common Areas (Primary): Learning neighborhoods and wide corridors have natural light.



Studios (Primary): Most furniture is not reconfigurable or easily movable.

Supporting Photographs



Cafeteria (Primary): Cafeteria has only one type of seating option.



Blackbox (Intermediate): Lack of storage areas. Blackbox currently used as storage/workroom.

Supporting Photographs



Exterior (Primary): Covered playground; community garden beds are undersized and not maintained well.



Exterior (Intermediate): Covered walkway at entry; raised community garden beds.

Supporting Photographs



Cafeteria (Intermediate): Cafeteria has a variety of seating options.



*Media Center (Intermediate, left): Transparency and flexible seating in the media center.
Reception (Intermediate, right): Welcoming reception space in the administrative area.*

Supporting Photographs

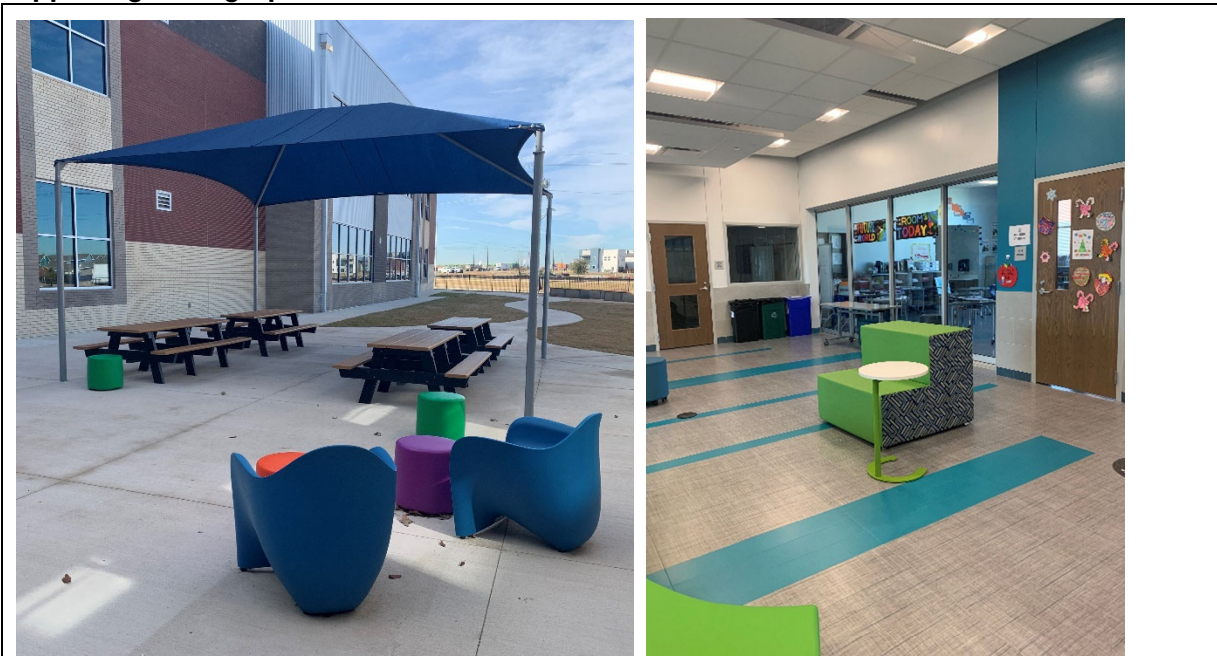

Outdoor Studio/Collaboration Space (Intermediate): Covered outdoor studio; open collaboration space with transparency between learning spaces.



Studio (Intermediate): Studios have a variety of furniture, movable glass walls and plenty of natural light.



Perkins&Will

Austin ISD Educational Suitability Assessment Criteria

General Building

School Name

Blazier Elementary School

Walk Attendees:

Jennifer Hoskins & Shani Saul

Date:

12/21/2020

1 - Exterior		1	2	3	4	5	N/A	8.75	100%	
1.1	Does the site permit desirable separation of vehicular, bus and pedestrian traffic?					5		Comments	1.00	5.00
	1 Very unsatisfactory - Bus, car and pedestrian all happen at the same location									
	2 Unsatisfactory - Cars and buses mix, pedestrians are separated									
	3 Average - Buses, cars, and pedestrians are separate but stack space is small									
	4 Satisfactory - Buses, cars, and pedestrians are separate but drop off does not have a canopy or a holding place like a commons or cafeteria									
	5 Very satisfactory - Buses, cars, and pedestrians are separate and drop off area has a canopy and destination									
	N/A Does not apply									
1.2	Is the building easily identified with appropriate signage and community wayfinding?					5		Comments	0.25	1.25
	1 Very unsatisfactory - Campus has no signage / wayfinding									
	2 Unsatisfactory - Signage/wayfinding is faded/hidden									
	3 Average - Signage / wayfinding visible but not apparent									
	4 Satisfactory - Signage / wayfinding is visible but not good condition									
	5 Very satisfactory - Signage and wayfinding is visible and easy to use									
	N/A Does not apply									

1 - Exterior (cont.)		1	2	3	4	5	N/A		
1.3	Is the dumpster accessible for trash / compost disposal?					5		Comments	0.50 2.50
1	Very unsatisfactory - No compost present, route has obstacles (stairs, curbs, barriers) to dumpster								
2	Unsatisfactory - Compost is present. Route has obstacles to dumpster								
3	Average - Compost is present (<100' to cafeteria), Route to dumpster is free and clear but the two are not directly adjacent.								
4	Satisfactory - Compost and dumpster are directly adjacent and route is barrier free								
5	Very Satisfactory - Compost and dumpster are directly adjacent and route is barrier free. Dumpster are shaped / positioned so people of all heights can access it.								
N/A	Does not apply								
2 - Outdoor Learning and Activity		1	2	3	4	5	N/A	15.00	87%
2.1	Are outdoor studios and support spaces appropriately configured per the ed spec?			3				Comments	1.00 3.00
1	Very unsatisfactory - No dedicated outdoor studios							The original campus has no outdoor studios. The new campus has multiple outdoor studios that are configured per the ed spec.	
2	Unsatisfactory - Too small, poor condition, disconnected from learning spaces, no flexibility, no shade provided								
3	Average - Adequate size, adequate condition, needs some renovations or updates to function well, 50% or less shade coverage over studio area								
4	Satisfactory - Good size, good condition, connected to learning spaces, good flexibility, more than 50% shade coverage over studio area								
5	Very satisfactory - Generous size, excellent condition, connected to learning spaces, excellent flexibility, full shade coverage over studio area								
N/A	Does not apply								
2.2	Are active playgrounds (elementary only) and support spaces configured per the ed spec?					5		Comments	1.00 5.00
1	Very unsatisfactory - No dedicated active playground							The playgrounds are fully covered, sizable and in excellent condition at both buildings.	
2	Unsatisfactory - Too small, poor condition, no shade provided								
3	Average - Adequate size, adequate condition, needs some renovations or updates to function well, 50% or less shade coverage over play structure								
4	Satisfactory - Good size, good condition, more than 50% shade coverage over play structure								
5	Very satisfactory - Generous size, excellent condition, full shade coverage over play structure								
N/A	Does not apply								

2 - Outdoor Learning and Activity (cont)		1	2	3	4	5	N/A			
2.3	Are gardens and support spaces appropriately configured per the ed spec? (evaluation on infrastructure not condition of plants)			3				Comments	0.00 0.00	
1	Very unsatisfactory - No dedicated gardens							The original building site has undersized garden beds in poor condition. The new building site has dedicated gardens in excellent condition per the ed spec. (Monitoring answer, does not affect score for Outdoor Learning and Activity.)		
2	Unsatisfactory - Too small, poor condition, disconnected from learning spaces, no flexibility, no accessible water source									
3	Average - Adequate size, adequate condition, needs some renovations or updates to function well, water source is difficult to access									
4	Satisfactory - Good size, good condition, connected to learning spaces, good flexibility, water source is accessible with 100 ft hose									
5	Very Satisfactory - Generous size, excellent condition, connected to learning spaces, excellent flexibility, water source is less than 50ft from the garden or has irrigation									
N/A	Does not apply									
2.4	Are the rain gardens and/or cisterns appropriately configured per the ed spec?				4			Comments	0.00 0.00	
1	Very unsatisfactory - No rain gardens or cisterns							The original building site has 2 small rainwater cisterns in good condition. The new building site has 2 large cisterns in excellent condition. (Monitoring answer, does not affect score for Outdoor Learning and Activity.)		
2	Unsatisfactory - Too small, poor condition, not functioning, disconnected									
3	Average - Adequate size, adequate condition, is connected, needs some renovations or updates to function well									
4	Satisfactory - Good size, good condition, functions properly									
5	Very Satisfactory - Generous size, excellent condition, exceptional functionality, connected to learning spaces, educational signage provided									
N/A	Does not apply									
2.5	Does the school have animal husbandry? (optional)	1						Comments	0.00 0.00	
1	No									
5	Yes									
2.6	Does the school have nature loop trails? (optional)	1						Comments	0.00 0.00	
1	No									
5	Yes									
2.7	Does the school have a learning pond? (optional)	1						Comments	0.00 0.00	
1	No									
5	Yes									
2.8	Does the school have a grass play field and walking trail?					5		Comments	1.00 5.00	
1	No									
5	Yes									

3 - General Building		1	2	3	4	5	N/A	11.25	82%
3.1	Are interior circulation routes wide enough to safely and effectively accommodate student movement?				4			Comments	0.50 2.00
1	Very unsatisfactory - Primary circulation is 5'-0" to 6'-0" wide	The primary corridors in the original building's academic wings are 8'-0" wide, but the corridors are 10'-0" + in the public areas adjacent to the library, gym and cafeteria.							
2	Unsatisfactory - Primary circulation is 6'-0" to 7'-0" wide								
3	Average - Primary circulation is 7'-0" to 8'-0" wide								
4	Satisfactory - Primary circulation is 8'-0"-10'-0" wide								
5	Very satisfactory - Primary circulation is 10'-0"+ wide								
N/A	Does not apply								
3.2	Are community use areas arranged so that the school can allow night functions without full school access?					5		Comments	0.75 3.75
1	Very unsatisfactory - Cafeteria, gym, and library cannot be accessed after hours								
2	Unsatisfactory - Only one of the public spaces (Cafeteria, Gym and Library) can be accessed from parking and secured after hours								
3	Average - Only two of the public spaces can be accessed from parking and secured after hours								
4	Satisfactory - All of the public spaces can be accessed from parking and secured from the rest of the building but not individually								
5	Very satisfactory - Cafeteria, gym, and library can be accessed from parking and locked off from rest of campus for night/evening use with their own entrance								
N/A	Does not apply								
3.3	Is there a community room that is a dedicated meeting space outside of school function?			3				Comments	0.75 2.25
1	Very unsatisfactory - No dedicated community room	The original building has no dedicated community room. The new building has a community room designed per the ed specs.							
2	Unsatisfactory - Community room but within school function, no access after school hours								
3	Average - Community room, moderate size, but need some renovations or updates to function well								
4	Satisfactory - Community room, good size /layout, meets needs /functions well								
5	Very Satisfactory - Community room, generous size, nice condition, functions appropriately outside of school function								
N/A	Does not apply								
3.4	Does the general appearance of the school convey pride for the students and community?					5		Comments	0.25 1.25
1	Very unsatisfactory - General appearance is poor								
2	Unsatisfactory - General appearance is aged but ok								
3	Average - General appearance is good								
4	Satisfactory - General appearance shows pride in campus and student works								
5	Very satisfactory - General appearance shows pride in campus and student works and is welcoming to the community								
N/A	Does not apply								

4 - Security		1	2	3	4	5	N/A	16.25	%
4.1	Does the facility have key card access at all major entries?							0.25	
1	Very unsatisfactory - No entries								
2	Unsatisfactory - 1/4 of major entries								
3	Average - 1/2 of major entries								
4	Satisfactory - 3/4 of major entries								
5	Very satisfactory - All of major entries								
N/A	Does not apply								
4.2	How adequate is site lighting and security for the campus overall?							1.00	
1	Very unsatisfactory - No exterior lighting, no secure perimeter								
2	Unsatisfactory - Lighting is limited to front entry only, parking lot lighting poor, security is minimal								
3	Average - Lighting at all night-use entries and parking lot, but poor condition. Security is moderate								
4	Satisfactory - Lighting at all night-use entries and parking lots, good condition, signage less visible, perimeter is well secured but needs updates								
5	Very satisfactory - Signage, parking lots, and entries are well lit, visible and easy to use, perimeter is very secure								
N/A	Does not apply								
4.3	Is the main office located at the school entry and configured with a secure vestibule to the main corridor?							1.00	
1	Very unsatisfactory - No secure vestibule, office located far from main entry, allows visitors access to school unsupervised								
2	Unsatisfactory - No secure vestibule, office located somewhat far from main entry, minimal supervision of visitors								
3	Average - Office close to entry, views of front door, but no secure vestibule								
4	Satisfactory - Office is well-located with a secure vestibule, but needs updates								
5	Very satisfactory - Office well-located with secure vestibule and all appropriate security features								
N/A	Does not apply								
4.4	Is there enough interior transparency for faculty to passively supervise learners and their activities who are not in studios?				4			1.00	4.00
1	Very unsatisfactory - No transparency of walls								
2	Unsatisfactory - Limited transparency in certain locations								
3	Average - Good transparency in certain locations but inadequate or missing in other locations of school								
4	Satisfactory - Adequate transparency throughout the school								
5	Very satisfactory - Excellent transparency throughout the school								
N/A	Does not apply								

The original building has narrow lites on doors and only certain locations have glazing in walls for teacher supervision. The new building has interior transparency designed per the ed specs.

5 - Environmental Quality		1	2	3	4	5	N/A	25.00	88%
5.1	How are acoustics in studios in general?			3				Comments	1.00 3.00
1	Very unsatisfactory - Recognized word/sound from adjacent studio/corridor								
2	Unsatisfactory - Audible sound from adjacent studio/corridor								
3	Average - Slight sound from outside room								
4	Satisfactory - Walls to deck insulated only white noise from mechanical system								
5	Very satisfactory - Able to hear quiet speaking from across the room								
N/A	Does not apply								
5.2	Is the studio artificial lighting adequate quality?					5		Comments	1.00 5.00
1	Very unsatisfactory - Sporadic lights work, glare, less than 20 FC								
2	Unsatisfactory - 10-19 FC or serious glare								
3	Average- 20-29 FC minor glare								
4	Satisfactory - 30-39 FC and no glare								
5	Very satisfactory - 40+ FC and no glare								
N/A	Does not apply								
5.3	Is there access to natural light in studios?					5		Comments	1.00 5.00
1	Very unsatisfactory - No learning spaces have natural light								
2	Unsatisfactory - 1-25% of learning spaces have natural light or windows are too small to let in light								
3	Average - 26-50% of learning spaces have natural light								
4	Satisfactory - 51-75% of learning spaces have natural light								
5	Very satisfactory - 76-100% of learning spaces have natural light								
N/A	Does not apply								
5.4	Is there access to outside views from learning spaces?					5		Comments	1.00 5.00
1	Very unsatisfactory - No learning spaces have views								
2	Unsatisfactory - 1-25% of learning spaces have views or windows are too small to see out								
3	Average - 26-50% of learning spaces have views								
4	Satisfactory - 51-75% of learning spaces have views								
5	Very satisfactory - 76-100% of learning spaces have views								
N/A	Does not apply								

5 - Environmental Quality (cont.)		1	2	3	4	5	N/A			
5.5	Does the building have odor or pest problems?				4			Comments	1.00 4.00	
1	Very unsatisfactory - Evidence of both pests and odors							In the original building, the group restrooms between Media Resources and admin had a strong odor.		
2	Unsatisfactory - Evidence of pests or odors									
3	Average - Limited evidence of pests, no odors									
4	Satisfactory - No evidence of pests / odors, school cleanliness in good condition									
5	Very Satisfactory - No evidence, school cleanliness in excellent condition									
N/A	Does not apply									
6 - Controllability of Systems		1	2	3	4	5	N/A	12.50	76%	
6.1	Does the studio thermostat allow for individual control?					5		Comments	0.50 2.50	
1	No									
5	Yes									
6.2	Are shades provided to control natural light in learning spaces?				4			Comments	1.00 4.00	
1	Very unsatisfactory - No, windows are covered with boards/paper									
2	Unsatisfactory - No, windows have no light control									
3	Average - Yes, but poor condition blinds									
4	Satisfactory - Yes, blinds									
5	Very satisfactory - Blackout shades									
N/A	Does not apply									
6.3	What is the quality of lighting controls in the studios?			3				Comments	1.00 3.00	
1	Very unsatisfactory - Single switch only per room									
2	Unsatisfactory - Alternating rows switch off									
3	Average - Alternating lamps in single fixtures switch off									
4	Satisfactory - Tri level switching									
5	Very satisfactory - Dimmable									
N/A	Does not apply									

7 - Furniture, Fixtures & Equipment		1	2	3	4	5	N/A	18.75	75%	
7.1	What is the current condition of the furniture?				4			Comments	0.75 3.00	
1	Very unsatisfactory - Damaged or broken, non-functioning	The original building does not have new furniture and the existing furniture is both outdated and heavy. The new building has new, flexible furniture in excellent condition.								
2	Unsatisfactory - Torn/ bent/ wrong size									
3	Average - Scratched/dented/marked									
4	Satisfactory - Not new, but sturdy and clean									
5	Very satisfactory - New									
N/A	Does not apply									
7.2	Are a variety of furniture types being accommodated throughout the school - learning commons, dining commons, other multi-use spaces?				4			Comments	1.00 4.00	
1	Very Unsatisfactory - Same furniture used in all spaces	The original building has some furniture variety in the media center, but all furniture in the learning studios and cafeteria is of the same type (chairs and elongated desks with storage). The new building has a large variety of furniture in all multi-use spaces.								
2	Unsatisfactory - Furniture variety in one multi-use space									
3	Average - Furniture variety in more than one multi-use space									
4	Satisfactory - All multi-use spaces have greater than one type of furniture									
5	Very satisfactory - All multi-use spaces have greater than two types of furniture									
N/A	Does not apply									
7.3	How well does furniture accommodate rapid reconfiguration of a space?			3				Comments	1.00 3.00	
1	Very Unsatisfactory - Furniture is fixed or very heavy	The majority of the furniture in the original building is not mobile and is cumbersome to move. Furniture in the new building can accommodate rapid reconfiguration very well.								
2	Unsatisfactory - Furniture does not allow desks to be configured as individuals, small groups, or large groups									
3	Average - Mix of furniture that can reconfigure but is cumbersome to move									
4	Satisfactory - Furniture is flexible for multiple configurations of space									
5	Very satisfactory - Furniture is flexible for multiple configurations of space, easy to move and stack									
N/A	Does not apply									
7.4	Is the furniture ergonomic and size appropriate for grade level?				4			Comments	1.00 4.00	
1	Very unsatisfactory - Desk with attached chair combinations too small for grade level	The furniture in the original building has tables with loose chairs, but the furniture is not adjustable in any way. The furniture in the new building is height-adjustable and sized appropriately per grade level.								
2	Unsatisfactory - Desk with attached chair combinations									
3	Average - Mix of studios with tables/loose chairs and desks with fixed seats									
4	Very satisfactory - Tables with loose chairs									
5	Very satisfactory - Tables with loose chairs that allow students to be active									
N/A	Does not apply									

Zero Waste		1	2	3	4	5	N/A	5.00	60%	
Do studios and corridors have blue recycle bins with bilingual instructions and/or image sorting instructions?				3				Comments	0.50 1.50	
1	Very unsatisfactory - There are no recycling and landfill bins and signage are sparse or infrequent, OR there are only landfill bins with no recycling bins.							A score for this category is being recorded, but this category is not calculated in the overall ESA average.		
2	Unsatisfactory - Bins and signage are sparse or infrequent and/or lack clear signage.									
3	Average - 50% of corridors and studios have both a landfill bin and a recycle bin in an accessible location. The containers have clear signage.									
4	Satisfactory - 75% of studios and corridors have a visible landfill and recycle collection containers in an accessible location. The containers have clear signage.									
5	Very satisfactory - All studios / corridors (100%) have visible landfill and recycle collection containers in accessible locations. The containers have clear signage, and the style and format is consistent and uniform across campus.									
N/A	Does not apply									
Does the cafeteria (or wherever meals are served) have at least one of each: green compost bin, blue recycle bin, and landfill bin? Are the bins labelled clearly with bilingual and/or image sorting?				3				Comments	0.50 1.50	
1	Very unsatisfactory- There may be landfill bins, but there are no compost and/or recycle bins. There is not clear sorting signage.							Recycling exists, but no compost was observed.		
2	Unsatisfactory- Recycle, landfill, and compost bins are present, but the bins are scattered and no co-located next to one another. Signage is absent or inconsistent.									
3	Average- There is at least one waste station with all three bins (recycle, compost, landfill) located with close proximity to one another. The signage is visible and consistent.									
4	Satisfactory- There are several waste stations as described above									
5	Very Satisfactory - There are several waste stations as described above, and additional signage in the cafeteria that encourages recycling/composting.									
N/A	Does not apply									



Austin ISD Educational Suitability Assessment Criteria

Academics - Elementary School

School Name

Blazier Elementary School

Walk Attendees:

Jennifer Hoskins, Shani Saul

Date:

12.21.20

8 - Academics & Learning		1	2	3	4	5	N/A	70.00	67%	
8.1	Are studios appropriately configured per the ed spec?				4			Comments	1.00 4.00	
1	Very unsatisfactory - Too small, no flexibility, disconnected	<p>In the original building, typical studios are approximately 900 SF and are connected to one adjacent studio, but there is limited transparency from studios to common areas and adjacent learning spaces. There are no movable walls in any of the learning studios. In the new building, studios are appropriately configured per the ed spec.</p>								
2	Unsatisfactory - Too small, only one area for all teaching methods, limited flexibility, disconnected									
3	Neutral - Adequate size, multiple areas for different teaching methods, adequate flexibility, limited transparency and connection to other studios and shared learning spaces, needs updates or renovations to function well.									
4	Satisfactory - Good size, multiple areas for different teaching methods, good flexibility, good transparency and connection to other studios and shared learning spaces									
5	Very Satisfactory - Generous size, multiple areas for different teaching methods, excellent flexibility, generous display area and visual teaching tools, excellent transparency and connection with other studios and shared learning spaces									
N/A	Does not apply									
8.2	Do Pre-K and Kinder have appropriate support spaces such as restrooms and storage per the ed spec?					5		Comments	1.00 5.00	
1	Very unsatisfactory - None provided	<p>Kindergarten is in its own wing with a shared restroom between two studios and one storage closet per studio.</p>								
2	Unsatisfactory - Too small, disconnected, poor condition									
3	Neutral - Adequate size, average condition, needs updates or renovations to function well									
4	Satisfactory - Good size, connected, good condition									
5	Very Satisfactory - Generous size, connected, excellent condition									
N/A	Does not apply									

8 - Academics & Learning (cont.)		1	2	3	4	5	N/A			
8.3	Do studios have appropriate support spaces such as storage per the ed spec?					5		Comments	1.00 5.00	
	1 Very unsatisfactory - None provided									
	2 Unsatisfactory - Too small, disconnected, poor condition									
	3 Neutral - Adequate size, average condition, needs updates or renovations to function well									
	4 Satisfactory - Good size, connected, good condition									
	5 Very Satisfactory - Generous size, connected, excellent condition									
	N/A Does not apply									
8.4	Do typical learning neighborhoods have small group rooms and open collaboration space?			3				Comments	1.00 3.00	
	1 Very unsatisfactory - No breakout rooms or open collaboration spaces are provided							The original building has a limited number of small group rooms with poor visual connection to open collaboration areas. The new building meets ed spec.		
	2 Unsatisfactory - Too small or too few, poor condition, no flexibility, lacks visual connection to learning neighborhood, poor acoustic privacy									
	3 Average - Adequate size, adequate condition, needs some renovations or updates to function well									
	4 Satisfactory - Good size, good condition and flexibility, transparency and connection to learning neighborhood, acoustic privacy									
	5 Very Satisfactory - Generous size, excellent condition and flexibility, transparency and connection to learning neighborhood, acoustic privacy									
	N/A Does not apply									
8.5	Are general studios large enough to support project-based learning and multiple teaching modalities?				4			Comments	1.00 4.00	
	1 Very unsatisfactory - Too small, no flexibility, does not support project-based learning							Studios in the original building are an average of 900 SF and are sized appropriately to support project-based learning, but new flexible furniture is needed to fully support project-based learning. Studios in the new building fully support project-based learning per the ed specs.		
	2 Unsatisfactory - Undersized, decentralized resources, limited flexibility									
	3 Average - Adequate size, needs some renovations or updates to function well									
	4 Satisfactory - Good size, centralized resources, good flexibility									
	5 Very Satisfactory - Generous size, centralized project resources, excellent flexibility									
	N/A Does not apply									

8 - Academics & Learning (cont.)		1	2	3	4	5	N/A			
8.6	Are Maker Spaces and support spaces appropriately configured per the ed spec?			3				Comments	1.00 3.00	
1	Very unsatisfactory - No dedicated maker spaces							No dedicated maker space exists in the original building, but students can use the collaboration space within the learning neighborhood. Maker spaces in the new building are configured per the ed specs.		
2	Unsatisfactory - Too small, poor condition, disconnected from learning spaces, no flexibility									
3	Average - Adequate size, adequate condition, needs some renovations or updates to function well									
4	Satisfactory - Good size, good condition, connected to learning spaces									
5	Very Satisfactory - Generous size, excellent condition, connected to learning spaces									
N/A	Does not apply									
8.7	Is there a Professional Learning Center in the learning neighborhood?			3				Comments	1.00 3.00	
1	Very unsatisfactory - No dedicated space for Professional Learning Center							No PLC in the learning neighborhood in the original building; the PLC is in excellent condition in the new building.		
2	Unsatisfactory - Too small, poor condition, disconnected									
3	Average - Adequate size, adequate condition, needs some renovations or updates to function well									
4	Satisfactory - Good size, good condition, connected									
5	Very Satisfactory - Generous size, excellent condition, connected									
N/A	Does not apply									
8.8	Is there a dedicated science room and support space?					5		Comments	0.00 0.00	
1	No							Monitoring answer, but doesn't affect overall score. There are dedicated science rooms in intermediate building.		
5	Yes									
8.9	Are there adequate places to display the evidence and artifacts of learning (both 2D and 3D)?		2					Comments	1.00 2.00	
1	Very unsatisfactory - No dedicated space							Only a few display cases and tack strips were observed at both campuses. The schools need more 2D & 3D display areas.		
2	Unsatisfactory - Too small, non-dedicated, poor condition									
3	Average - Adequate size, adequate condition, needs updates or renovations to function well									
4	Satisfactory - Good size, good condition									
5	Very Satisfactory - Generous size, excellent condition									
N/A	Does not apply									

8 - Academics & Learning (cont.)		1	2	3	4	5	N/A			
8.10	Does the building provide adequate opportunities for students/teachers to collaborate in varying group sizes?				4			Comments	1.00 4.00	
1	Very unsatisfactory - No space to support collaboration in various sizes.						The original building lacks acoustical privacy with group options only possible in open areas.			
2	Unsatisfactory - Too small, inflexible, only one option, does not support a variety of group sizes									
3	Average - Adequate space for collaboration, needs updates or renovations to function well.									
4	Satisfactory - Good size, good condition, multiple options to support a variety of group sizes									
5	Very Satisfactory - Generous size, excellent condition, multiple options to support a variety of group sizes									
N/A	Does not apply									
8.11	Does the building provide opportunities for informal interaction?			3				Comments	1.00 3.00	
1	Very unsatisfactory - No space						The original building does not have any furniture in the open areas in the learning neighborhoods or hallways to encourage more informal social interaction. The new building meets ed spec.			
2	Unsatisfactory - Too small, poor condition, layout and furnishings do not support informal interaction well									
3	Average - Adequate size and condition, needs updates or renovations to function well.									
4	Satisfactory - Good size, good condition, layout and furnishings support informal interactions									
5	Very Satisfactory - Generous size, excellent condition, layout and furnishings support informal interactions									
N/A	Does not apply									
8.12	Does the learning neighborhood / building provide adequate opportunities for students to work independently?				4			Comments	1.00 4.00	
1	Very unsatisfactory - No breakout rooms/small study spaces						The original building needs updates and flexible furnishings to fully support independent student work. The new building meets ed spec.			
2	Unsatisfactory - Too small, poor condition, no acoustic privacy, only one space for independent work, disconnected from learning neighborhood									
3	Average - Adequate size and condition, needs updates or renovations to function well.									
4	Satisfactory - Good size and condition, acoustic privacy, variety of independent work space options, connected to learning neighborhood									
5	Very Satisfactory - Generous size, excellent condition, acoustic privacy, variety of independent work space options, connected to learning neighborhood									
N/A	Does not apply									

8 - Academics & Learning (cont.)										
8.13	Are Special Education spaces appropriately configured per the ed spec?				3				Comments	1.00 3.00
	1	Very unsatisfactory - Too small, no flexibility, disconnected					Some special education classes are being held in portables at the original building site. Special education spaces are configured per the ed specs in the new building.			
	2	Unsatisfactory - Too small, only one area for all teaching methods, limited flexibility, disconnected								
	3	Neutral - Adequate size, multiple areas for different teaching methods, adequate flexibility, limited transparency and connection to other studios and shared learning spaces, needs updates or renovations to function well.								
	4	Satisfactory - Good size, multiple areas for different teaching methods, good flexibility, good transparency and connection to other studios and shared learning spaces								
	5	Very Satisfactory - Generous size, multiple areas for different teaching methods, excellent flexibility, generous display area and visual teaching tools, excellent transparency and connection with other studios and shared learning spaces								
	N/A	Does not apply								
8.14	Are Special Education support spaces, such as storage, space for washer/dryer, appropriately configured per the ed spec?				3			Comments	1.00 3.00	
	1	Very unsatisfactory - None provided					No washer/dryer or life skills kitchen were found in the original building. Special education spaces are configured per the ed specs in the new building.			
	2	Unsatisfactory - Too small, disconnected, poor condition								
	3	Neutral - Adequate size, average condition, needs updates or renovations to function well								
	4	Satisfactory - Good size, connected, good condition								
	5	Very Satisfactory - Generous size, connected, excellent condition								
	N/A	Does not apply								
8.15	Are Accessible restrooms and changing rooms readily available to the Special Education spaces?		1					Comments	1.00 1.00	
	1	No					No changing room was found in the original building; some special education spaces are in portables.			
	5	Yes								

9 - Visual and Performing Arts		1	2	3	4	5	N/A	15.00	100%	
9.1	Are music spaces and the cafeteria stage appropriately configured per the ed spec?					5		Comments	1.00 5.00	
	1 Very unsatisfactory - Too small, missing program spaces									
	2 Unsatisfactory - Too small, poor condition									
	3 Neutral - Adequate size, adequate condition, needs updates or renovations to function well.									
	4 Satisfactory - Good size, good condition									
	5 Very Satisfactory - Generous size, excellent condition									
	N/A Does not apply									
9.2	Are music and performance storage spaces appropriately configured per the ed spec?					5		Comments	1.00 5.00	
	1 Very unsatisfactory - None provided									
	2 Unsatisfactory - Too small, disconnected, poor condition									
	3 Neutral - Adequate size, average condition, needs updates or renovations to function well									
	4 Satisfactory - Good size, connected, good condition									
	5 Very Satisfactory - Generous size, connected, excellent condition									
	N/A Does not apply									
9.3	Are Visual Arts spaces and storage appropriately configured per the ed spec?					5		Comments	1.00 5.00	
	1 Very unsatisfactory - Too small, missing program spaces									
	2 Unsatisfactory - Too small, poor condition									
	3 Average - Adequate size, adequate condition, needs some renovations or updates to function well									
	4 Satisfactory - Good size, good condition									
	5 Very Satisfactory - Generous size, excellent condition									
	N/A Does not apply									

10 - PE and Wellness		1	2	3	4	5	N/A	10.00	90%
10.1	Does the campus meet the ed spec standard for physical education program spaces?				4			Comments	1.00 4.00
	1 Very unsatisfactory - Too small, missing program spaces 2 Unsatisfactory - Too small, poor condition 3 Average - Adequate size, adequate condition, needs some renovations or updates to function well 4 Satisfactory - Good size, good condition 5 Very Satisfactory - Generous size, excellent condition N/A Does not apply	The gymnasium restrooms are only 50 SF in the original building instead of 150 SF each.							
10.2	Are the physical education storage spaces appropriately configured per the ed spec?					5		Comments	1.00 5.00
	1 Very unsatisfactory - None provided 2 Unsatisfactory - Too small, disconnected, poor condition 3 Neutral - Adequate size, average condition, needs updates or renovations to function well 4 Satisfactory - Good size, connected, good condition 5 Very Satisfactory - Generous size, connected, excellent condition N/A Does not apply								
11 - Food Services		1	2	3	4	5	N/A	10.00	90%
11.1	Is the Dining Commons appropriately configured per the ed spec?				4			Comments	1.00 4.00
	1 Very unsatisfactory - Too small, missing program spaces 2 Unsatisfactory - Too small, poor condition, only one option for eating space provided, inadequate circulation 3 Average - Adequate size and condition, needs updates or renovations to function well 4 Satisfactory - Good size and condition, good circulation, multiple options for eating space (ex: connection to outdoor eating space) 5 Very Satisfactory - Generous size, excellent condition and circulation, multiple options for eating space (ex: connection to outdoor eating space) N/A Does not apply	The original building has no outdoor dining space and only one option for eating space. The new building has multiple options for eating spaces.							
11.2	Are the Food Services support spaces appropriately configured per the ed spec?					5		Comments	1.00 5.00
	1 Very unsatisfactory - None provided 2 Unsatisfactory - Too small, disconnected, poor condition 3 Neutral - Adequate size, average condition, needs updates or renovations to function well 4 Satisfactory - Good size, connected, good condition 5 Very Satisfactory - Generous size, connected, excellent condition N/A Does not apply								

12 - Media Resources		1	2	3	4	5	N/A	30.00	93%	
12.1	Is the Library/Media Center easily accessible for the occupants and visitors to the school?					5		Comments	1.00 5.00	
	1 Very unsatisfactory - Not accessible									
	2 Unsatisfactory - Limited access, difficult to find, no transparency									
	3 Average - Adequate accessibility, needs updates or renovations to function well									
	4 Satisfactory - Accessible, easy to find, good transparency, good condition									
	5 Very Satisfactory - Accessible, easy to find, excellent transparency, excellent condition									
	N/A Does not apply									
12.2	How well does the Library/Media Center support quiet study?				4			Comments	1.00 4.00	
	1 Very unsatisfactory - No quiet study spaces								No breakout spaces are adjacent to the library, but a variety of mobile furniture and good acoustics in both buildings support quiet study well.	
	2 Unsatisfactory - One area in poor condition, poor acoustic privacy									
	3 Average - One or more areas provided, needing updates or renovations to function well									
	4 Satisfactory - Clusters or small rooms adjacent to media center, good condition, good acoustic privacy									
	5 Very Satisfactory - Multiple clusters or small rooms adjacent to media center, excellent condition, excellent acoustic privacy									
	N/A Does not apply									
12.3	How well does the Library/Media Center support social interaction?					5		Comments	1.00 5.00	
	1 Very unsatisfactory - No space									
	2 Unsatisfactory - Too small, poor condition, layout and furnishings do not support informal interaction well									
	3 Average - Adequate size and condition, needs updates or renovations to function well.									
	4 Satisfactory - Good size, good condition, layout and furnishings support informal interactions									
	5 Very Satisfactory - Generous size, excellent condition, layout and furnishings support informal interactions									
	N/A Does not apply									
12.4	How well does the Library/Media Center support collaborative work in small groups (4-8 students)?				4			Comments	1.00 4.00	
	1 Very unsatisfactory - No breakout rooms, no flexible furniture, no support								No breakout spaces are adjacent to the library, but a variety of mobile furniture and good acoustics in both buildings support small group work well.	
	2 Unsatisfactory - Too small, one area, poor condition									
	3 Average - Adequate size, multiple areas provided, needing updates or renovations to function well									
	4 Satisfactory - Clusters or small rooms adjacent to media center, flexible furniture, good condition									
	5 Very Satisfactory - Multiple clusters or small rooms adjacent to media center, flexible furniture, excellent condition									
	N/A Does not apply									

12 - Media Resources - Continued		1	2	3	4	5	N/A			
12.5	How well does the Library/Media Center support collaborative work in larger groups (10-25)?					5		Comments	1.00 5.00	
	1 Very unsatisfactory - No gathering areas									
	2 Unsatisfactory - Too small, one common space, limited seating, poor condition									
	3 Average - Adequate size, one common space, needs updates or renovations to function well									
	4 Satisfactory - Good size, multiple common spaces with seating, good condition									
	5 Very Satisfactory - Generous size, multiple commons spaces with seating, excellent condition									
	N/A Does not apply									
12.6	How well does the Library/Media Center support technology?					5		Comments	1.00 5.00	
	1 Very unsatisfactory - No vis comm tools								The original building has Apple desktops, 2 projector screens, and multiple mobile digital screens. The new building supports technology per the ed specs.	
	2 Unsatisfactory - Outdated, poorly functioning, or insufficient									
	3 Good - Mix of old and new whiteboards/projectors/etc.									
	4 Satisfactory - Projectors, marker boards, smart boards in most spaces - good condition									
	5 Very Satisfactory - Projectors, marker boards, smart boards in most spaces - new condition									
	N/A Does not apply									
13 - Technology		1	2	3	4	5	N/A		20.00 65%	
13.1	How well equipped are the facilities with instructional technology?					5		Comments	1.00 5.00	
	1 Very unsatisfactory - Limited to no technology present in instructional spaces								Multiple types of technology exist, including digital display screens and projectors.	
	2 Unsatisfactory - One type of technology present									
	3 Average - Multiple types of technology, smart boards, poor condition, limited to only certain areas of school									
	4 Satisfactory - Multiple types of technology, smart boards, good condition.									
	5 Very Satisfactory - Multiple types of technology, smart boards, excellent condition									
	N/A Does not apply									
13.2	Is there an adequate number of power and data outlets in learning spaces?			3				Comments	1.00 3.00	
	1 Very unsatisfactory - Outlet configuration does not support digital devices throughout school (1 per wall)								An average of 2 outlet quads per wall exist at the original building (8 total outlets per wall). An average of 2 outlet locations per wall exist at the new building (4 total outlets).	
	2 Unsatisfactory - Outlet configuration support digital devices only in certain areas of school (2 per wall)									
	3 Average - Outlet configuration support digital devices but not enough capacity throughout school (3 per wall)									
	4 Satisfactory - Outlet configuration support digital devices with adequate coverage and capacity throughout school (>3 per wall)									
	5 Very Satisfactory - Excellent outlet configuration to support digital devices throughout school (>3 per wall)									
	N/A Does not apply									

13 - Technology (cont.)		1	2	3	4	5	N/A			
13.3	Are there adequate charging locations for devices?	1						Comments	1.00	1.00
1	Very unsatisfactory - No centralized charging location							No charging locations were observed.		
2	Unsatisfactory - Centralized charging location, but inadequate in size for number of devices									
3	Average - Charging cart or tower but not adequately sized for number of devices									
4	Satisfactory - Charging cart or tower not centralized									
5	Very Satisfactory - Charging cart or tower located centralized location. Excellent condition									
N/A	Does not apply									
13.4	Is there adequate AV for presentations spaces – cafeteria and gym?				4			Comments	1.00	4.00
1	Very unsatisfactory - AV not present in one or more space							In the original building, the mobile projection screen is shared with the gym. The screen appears small and outdated. The A/V in the new building is designed per ed specs.		
2	Unsatisfactory - AV undersized for room, poor condition									
3	Average - Adequately sized / poor condition OR AV undersized / adequate condition									
4	Satisfactory - Good size, good condition									
5	Very Satisfactory - Generous sized, excellent condition									
N/A	Does not apply									
13.5	Is there digital media signage at the reception area?				4			Comments	0.00	0.00
1	Very unsatisfactory - No digital media present in reception area							The location of the digital media signage is not ideal at the old building as it faces away from visitors. The digital media signage at the new building functions very well.		
2	Unsatisfactory - Undersized, poor condition									
3	Average - Adequately sized / poor condition OR undersized / adequate condition									
4	Satisfactory - Media signage present, good sized, good condition									
5	Very Satisfactory - Generously sized, excellent condition									
N/A	Does not apply									

14 - Administration Spaces		1	2	3	4	5	N/A	20.00	85%
14.1	Is there a reception area that functions as a security checkpoint for all visitors?							1.00	
	1 Very unsatisfactory - No security checkpoint								
	2 Unsatisfactory - Checkpoint is too small, poor condition								
	3 Average - Needs updates or renovations to function well								
	4 Satisfactory - Good size, good condition								
	5 Very Satisfactory - Generous size, excellent condition								
	N/A Does not apply								
14.2	Does the administration area feel welcoming?					5		1.00	5.00
	1 Very unsatisfactory - No welcome space								
	2 Unsatisfactory - Too small, poor lighting and transparency, limited informal seating, poor condition								
	3 Average - Adequate size and layout, needs updates or renovations to feel welcoming								
	4 Satisfactory - Good size and layout, good lighting and transparency, informal seating provided								
	5 Very Satisfactory - Generous size and layout, plenty of light and transparency, informal seating provided, excellent condition								
	N/A Does not apply								
14.3	For those spaces that require it, does the administration area have adequate acoustic privacy?				4			1.00	4.00
	1 Very unsatisfactory - No acoustic separations								
	2 Unsatisfactory - Acoustic separations do not perform well								
	3 Average - Some acoustic separations function okay, but portions need updates or renovations								
	4 Satisfactory - Good acoustic separations								
	5 Very Satisfactory - Excellent acoustic separations								
	N/A Does not apply								
14.4	Are conference rooms easily accessed for public / parent use?				4			1.00	4.00
	1 Very unsatisfactory - Not accessible for public/parent use								
	2 Unsatisfactory - Limited access, no transparency, poor condition, difficult to find								
	3 Average - Adequate accessibility, needs updates or renovations to function well								
	4 Satisfactory - Good accessibility, good transparency, good size and condition								
	5 Very Satisfactory - Excellent accessibility, excellent transparency, generous size, excellent condition								
	N/A Does not apply								

The community can access either building for after-hours functions without full school access. The intermediate building has a large, spacious community room and a conference room for community use.